



Challenges

- 1 full year of new construct for 4 CTE spaces before renovations can begin and then 3 full years and 3 additional summers beyond that of renovation/disruption 350-400
- Students would need to be located off-site at McIntosh College for 3 years. This means:
 - Investment in accessibility upgrades including an elevator, additional toilets, and site grading
 - Investment in structural upgrades to make roof acceptable
 - Investment in some finishes, handrails and some technology to makes spaces useable for HS students
 - Electric heating of 1/3rd of building will be costly
 - Investment in approximately 4 additional modular classrooms
 - Investment in extra teachers, transportation, food service distribution
- Alternative approach would be locating students in approximately 16 modular classrooms on the high school site at a cost of \$TBD
 - Challenges with this approach include either elimination of most current parking, or elimination of at least 1 ball field for 3 years. (area required for 16 classrooms needs verification. 2 Crs = 60'x 24')
- Challenges of either approach include:
 - Ongoing disruption to students' schedule and learning Negative impact on tuition student program Construction workers and student crossing paths.

Full Rehabilitation - Phase 1 - Year 1

Dover HS / CTC

Dover, NH

UPDATED 04/07/2015

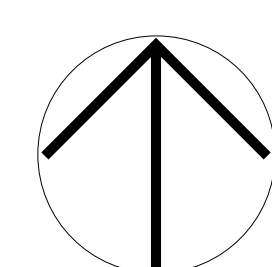

HMFH Architects Inc.



- Asbestos removal
- New bracings
- New systems. Access ceilings as necessary after hours
- New rooftop units for entire building
- All new finishes
- New roof-top air handling units

SCALE 1/16"
2nd FLOOR
 Phase 2 Year 2

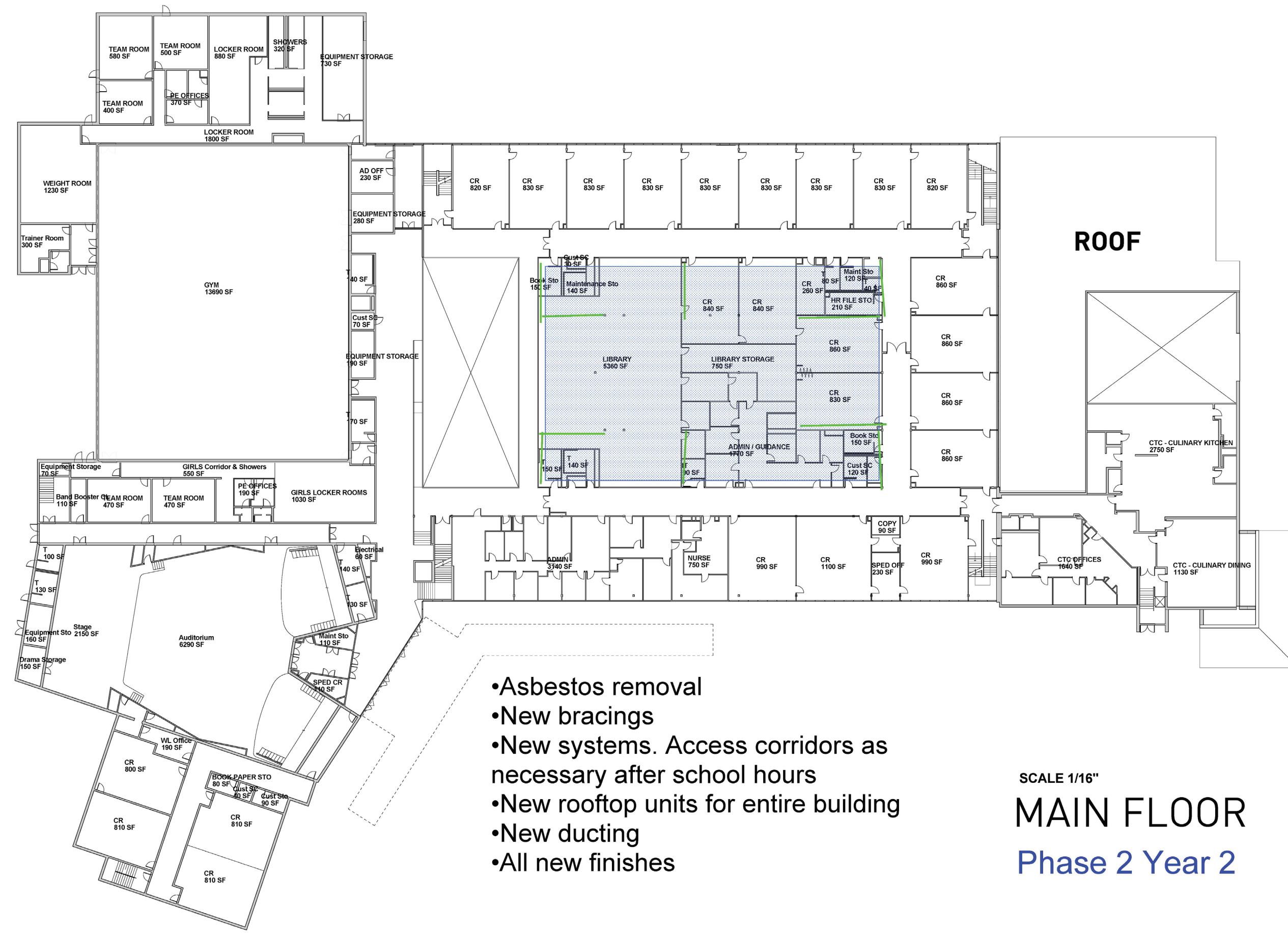

- Asbestos removal
- New bracings
- New systems. Access corridors as necessary after school hours
- New rooftop units for entire building
- New ducting
- All new finishes

SCALE 1/16"
MAIN FLOOR
 Phase 2 Year 2

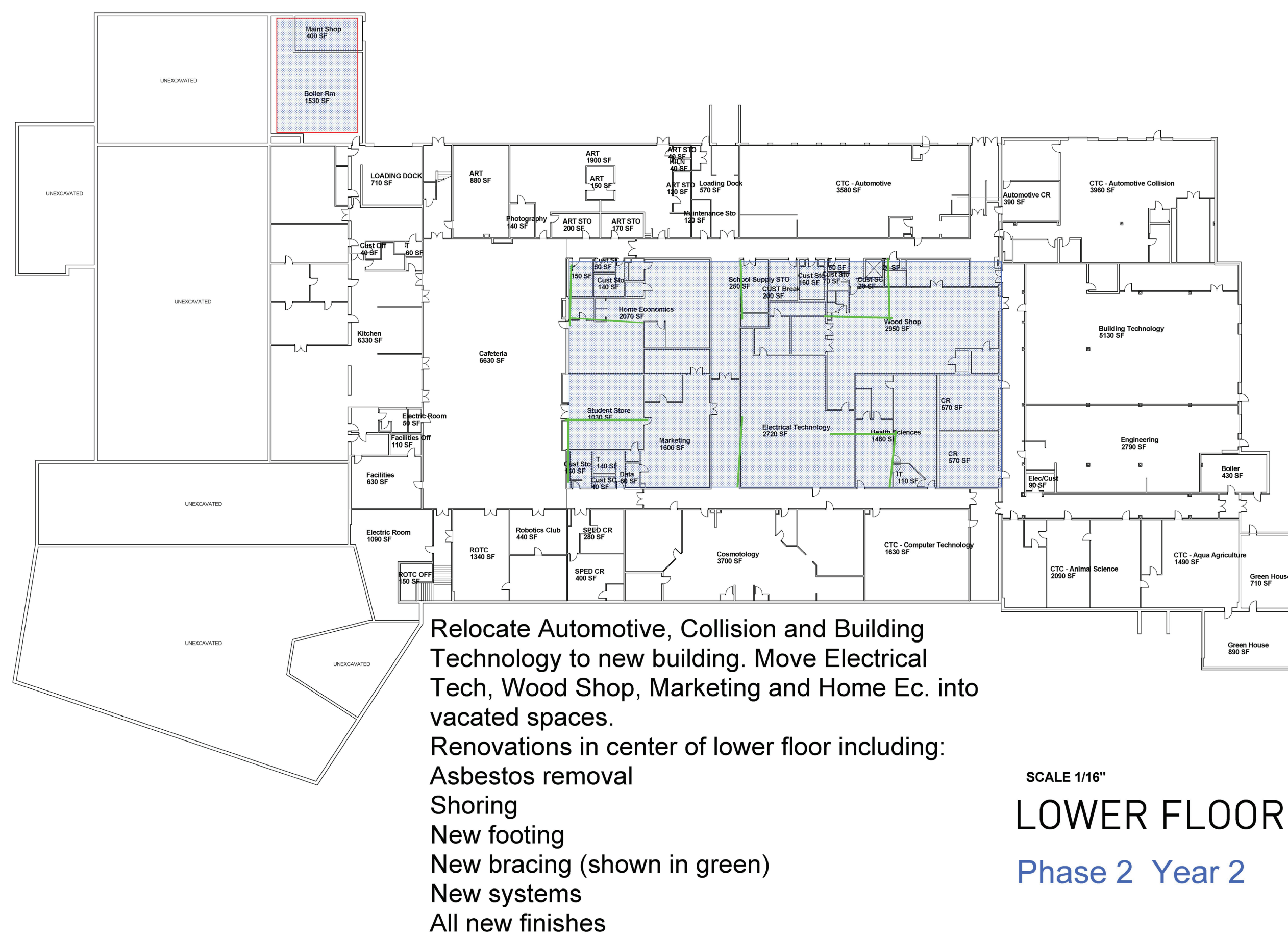

- Relocate Automotive, Collision and Building Technology to new building. Move Electrical Tech, Wood Shop, Marketing and Home Ec. into vacated spaces.
- Renovations in center of lower floor including:
- Asbestos removal
- Shoring
- New footing
- New bracing (shown in green)
- New systems
- All new finishes

SCALE 1/16"
LOWER FLOOR
 Phase 2 Year 2

Full Rehabilitation - Phase 2 - YEAR 2

Dover HS / CTC

Dover, NH
 Updated 04/21/2015

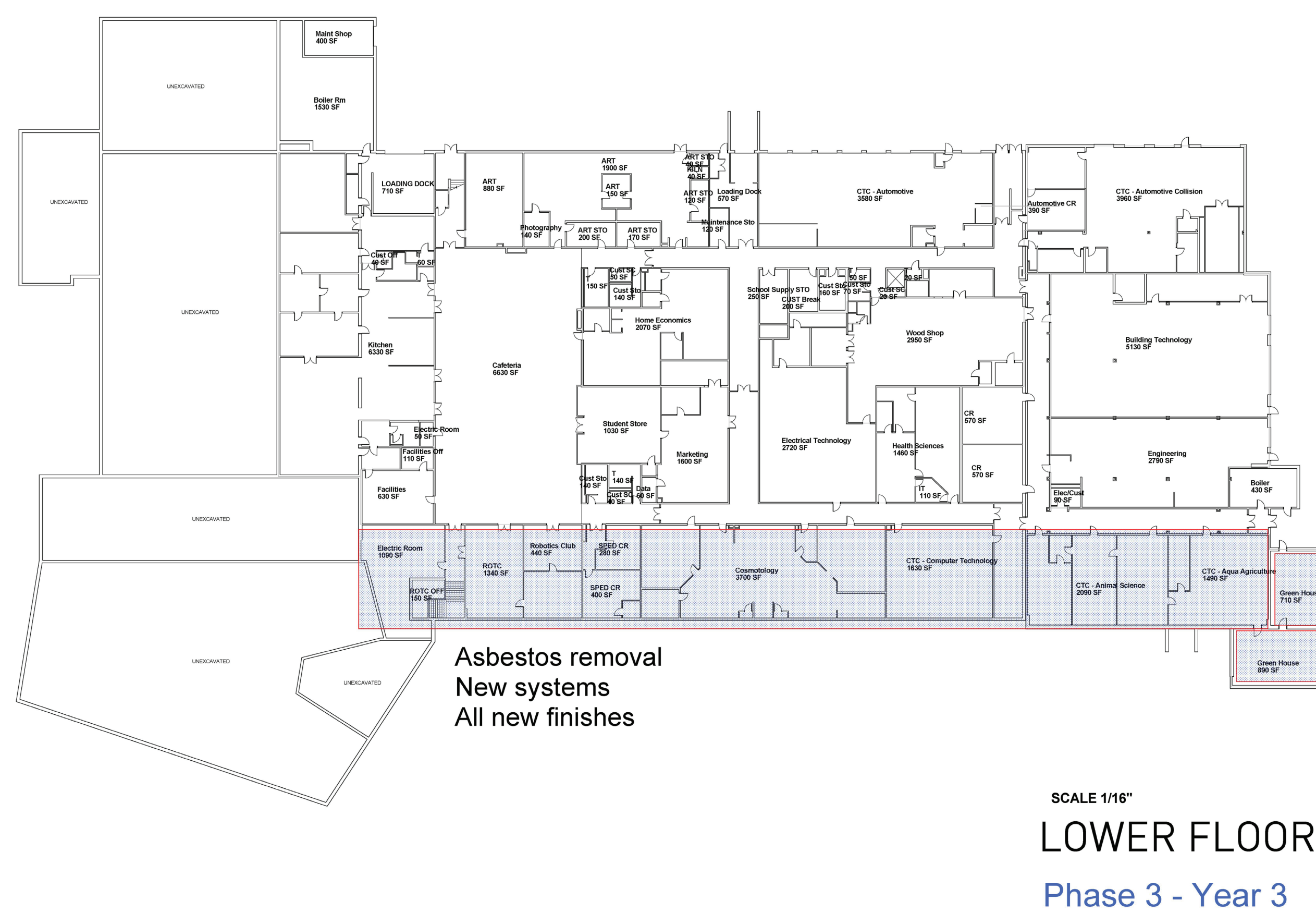
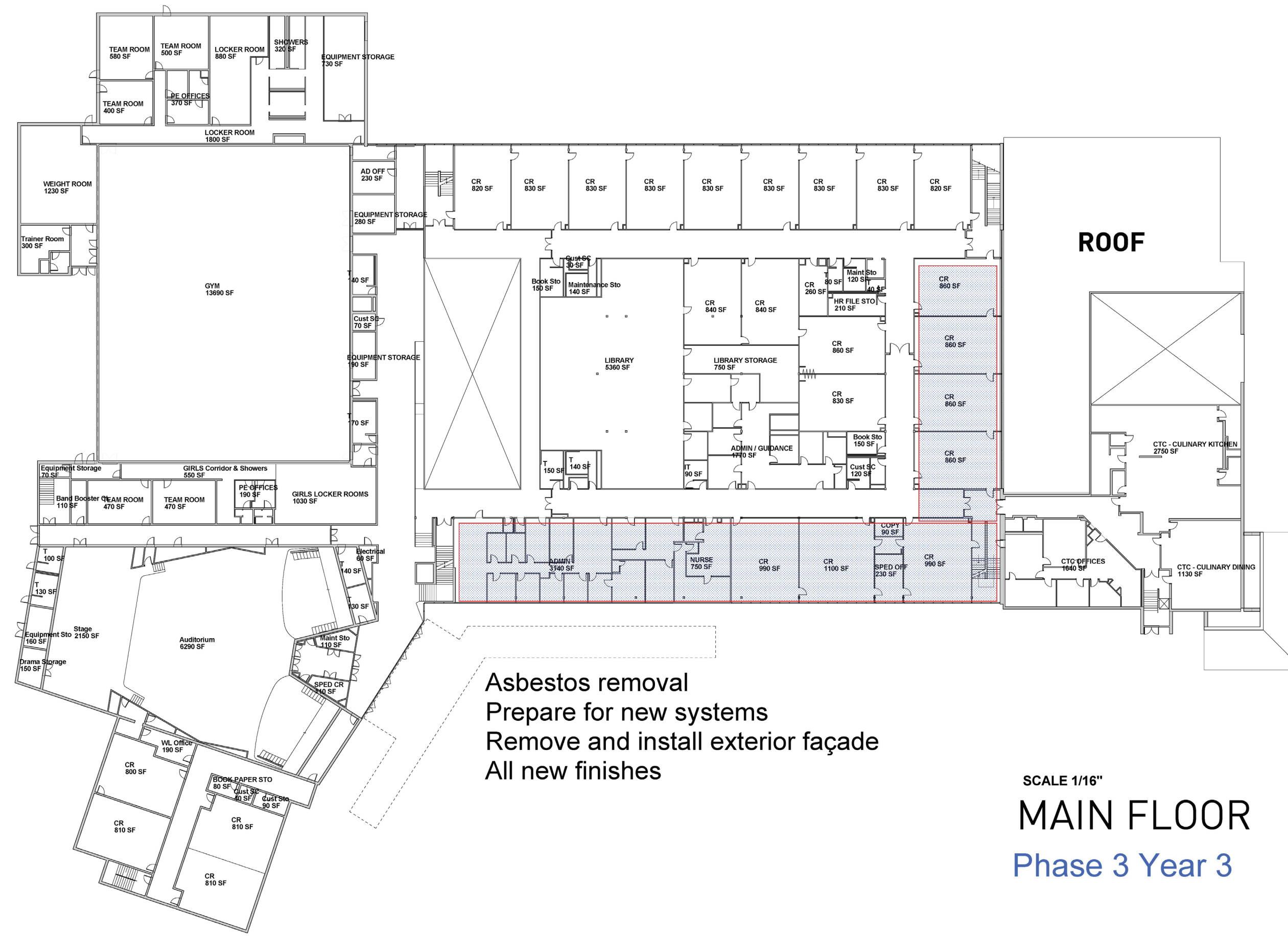
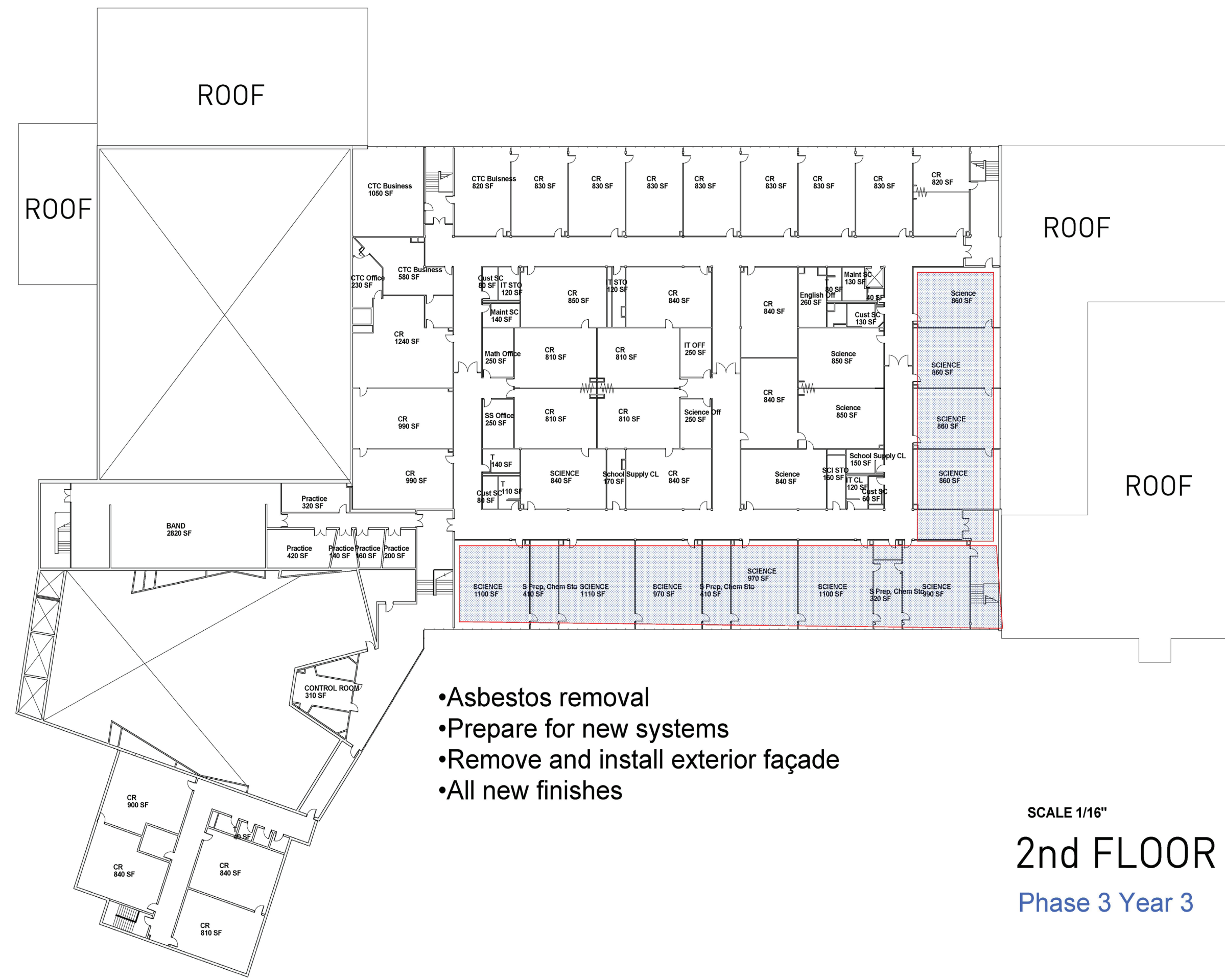

Full Rehabilitation - Phase 3 - YEAR 3

Dover HS / CTC

Dover, NH
 Updated 04/21/2015

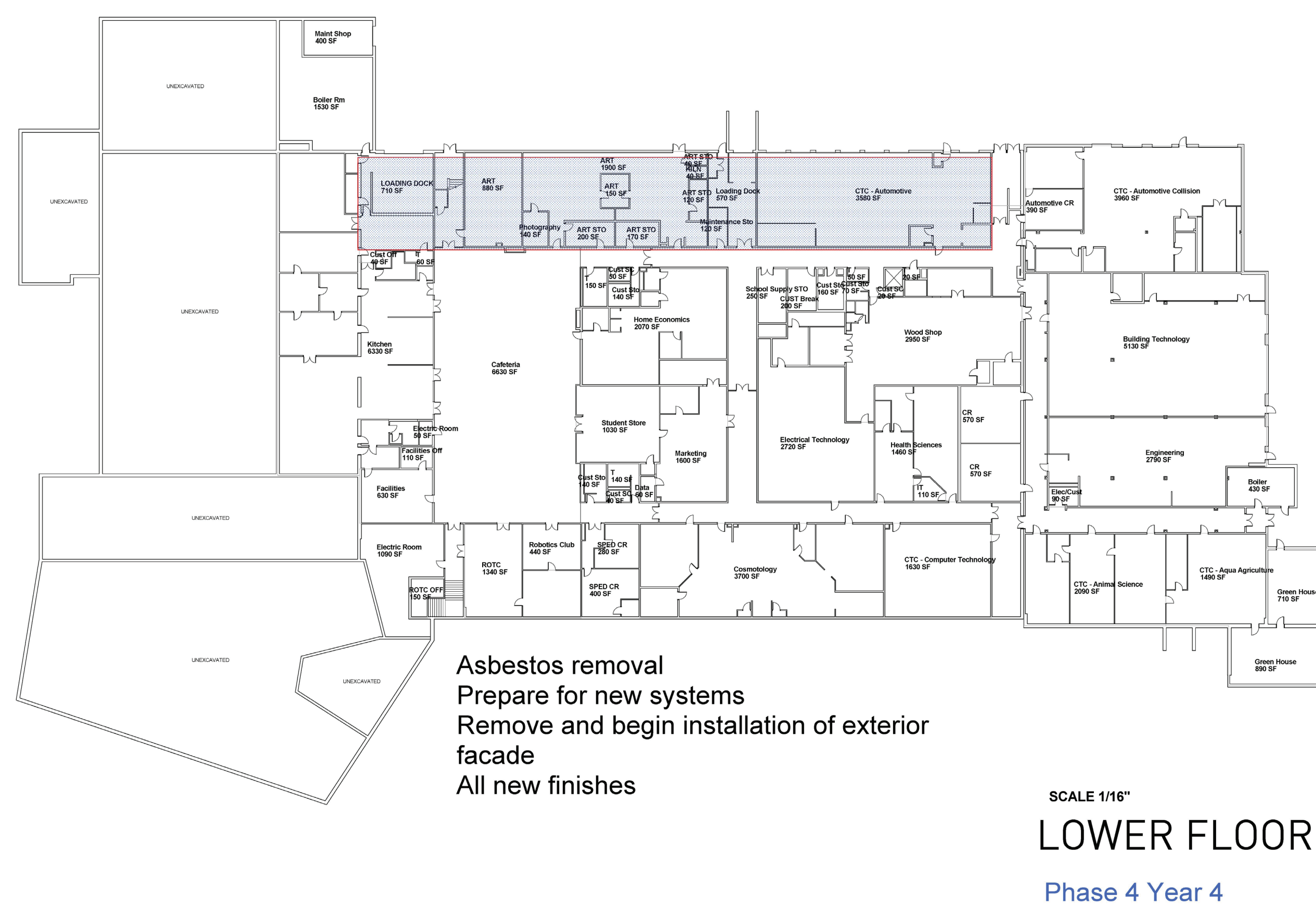
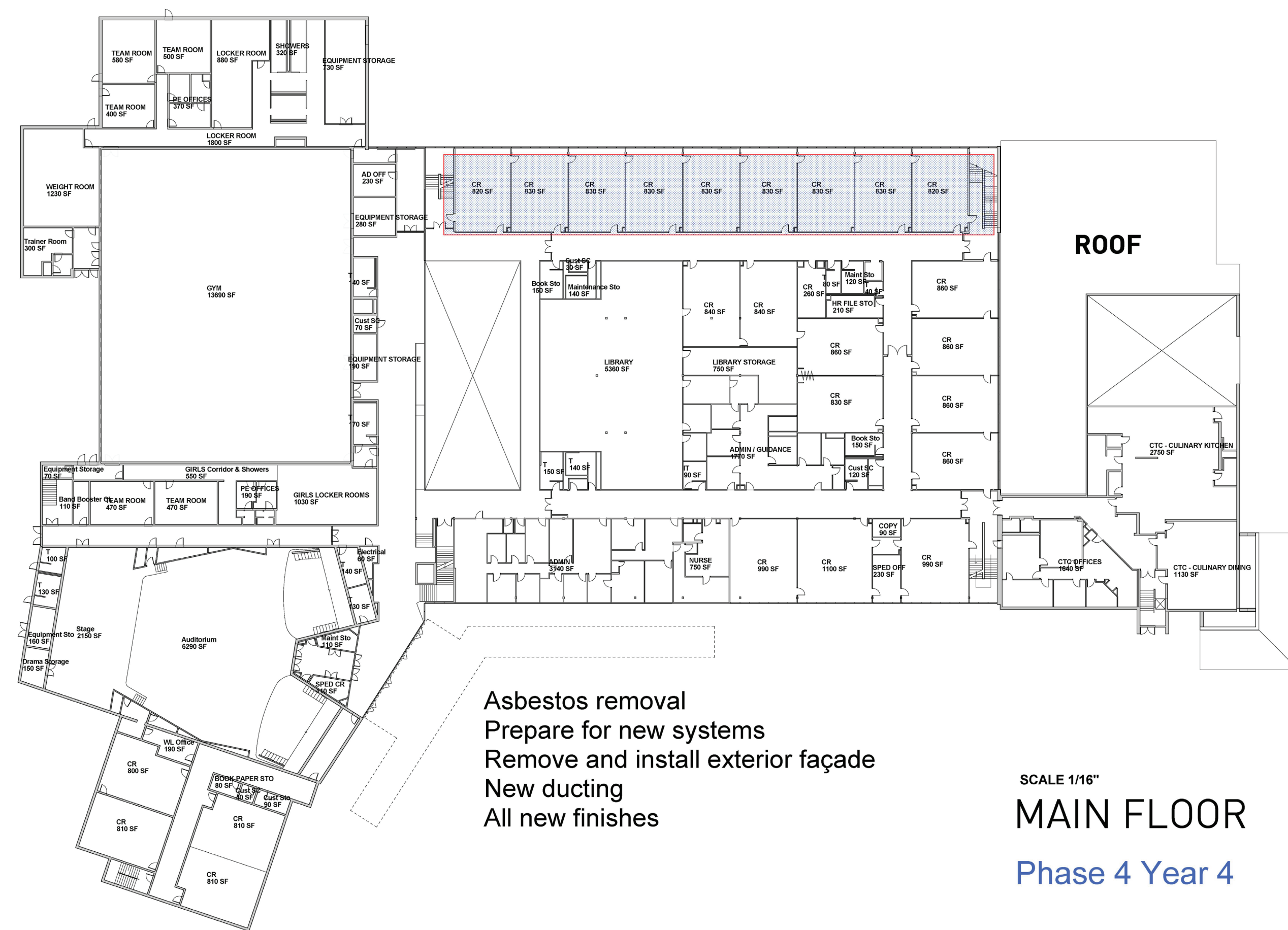
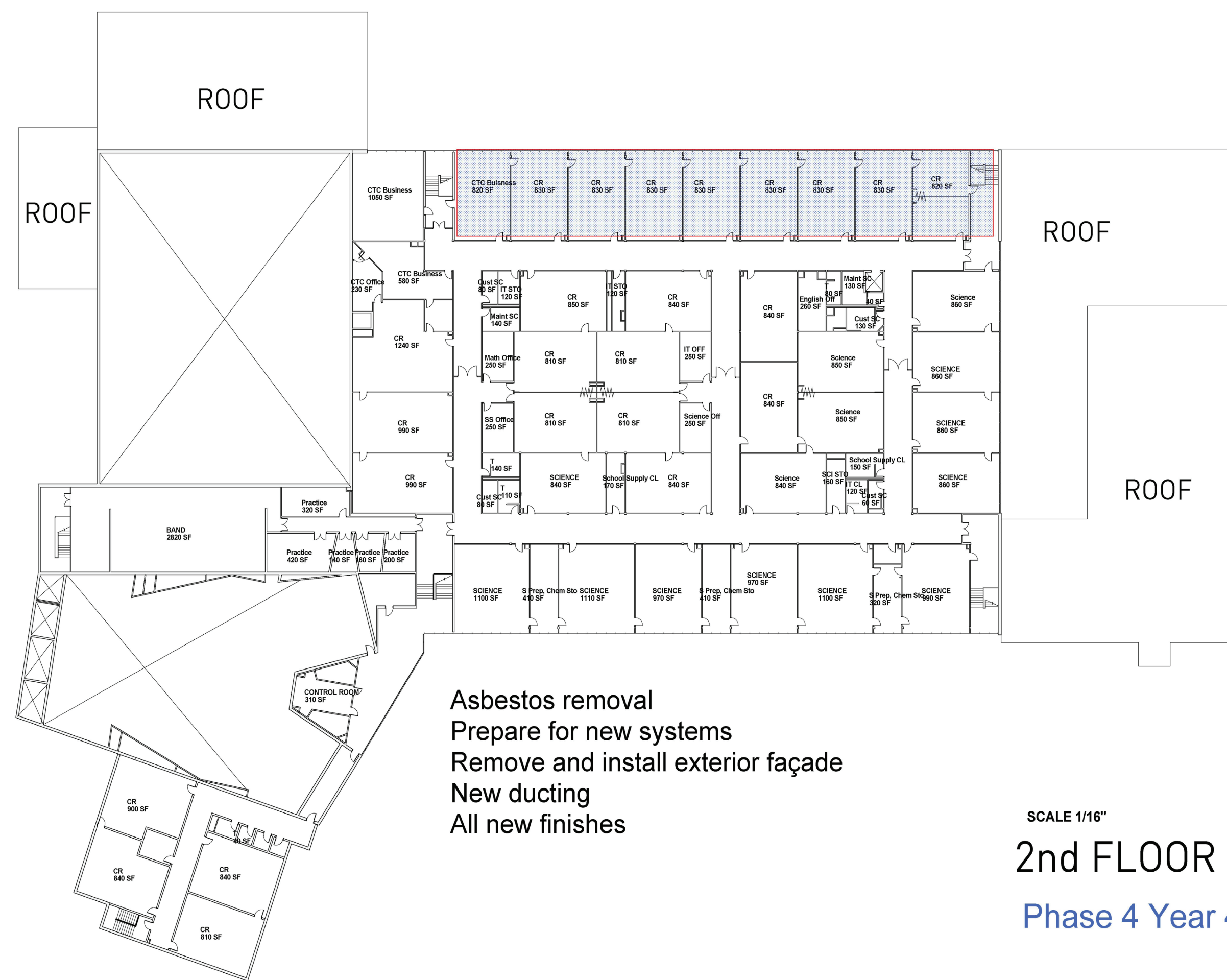

Full Rehabilitation - Phase 4 - YEAR 4

Dover HS / CTC

Dover, NH
Updated 04/21/2015

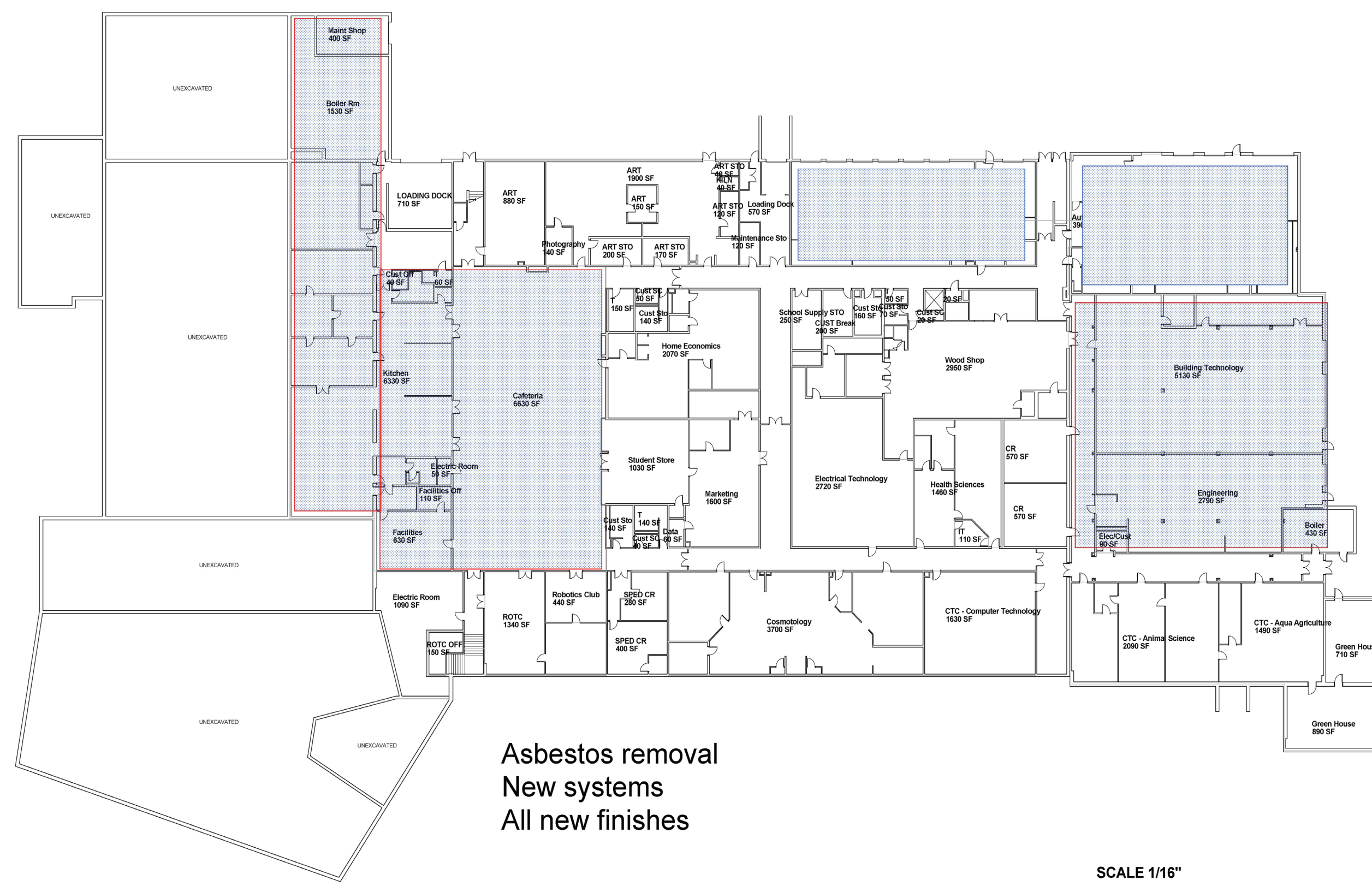

SCALE 1/16"
LOWER FLOOR
 Phase 5 Summer
 5 Year 5

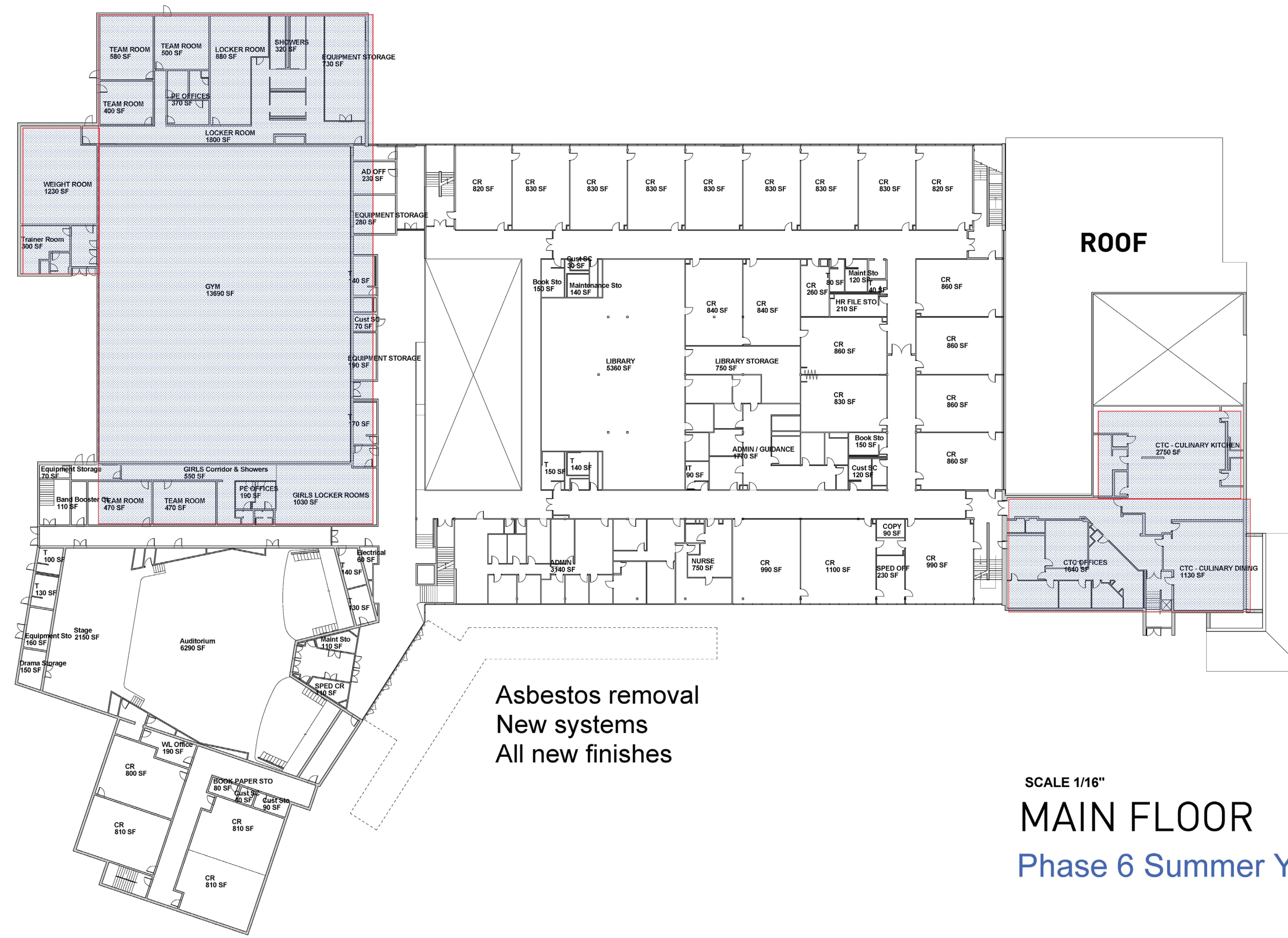

SCALE 1/16"
MAIN FLOOR
 Phase 6 Summer Year 6

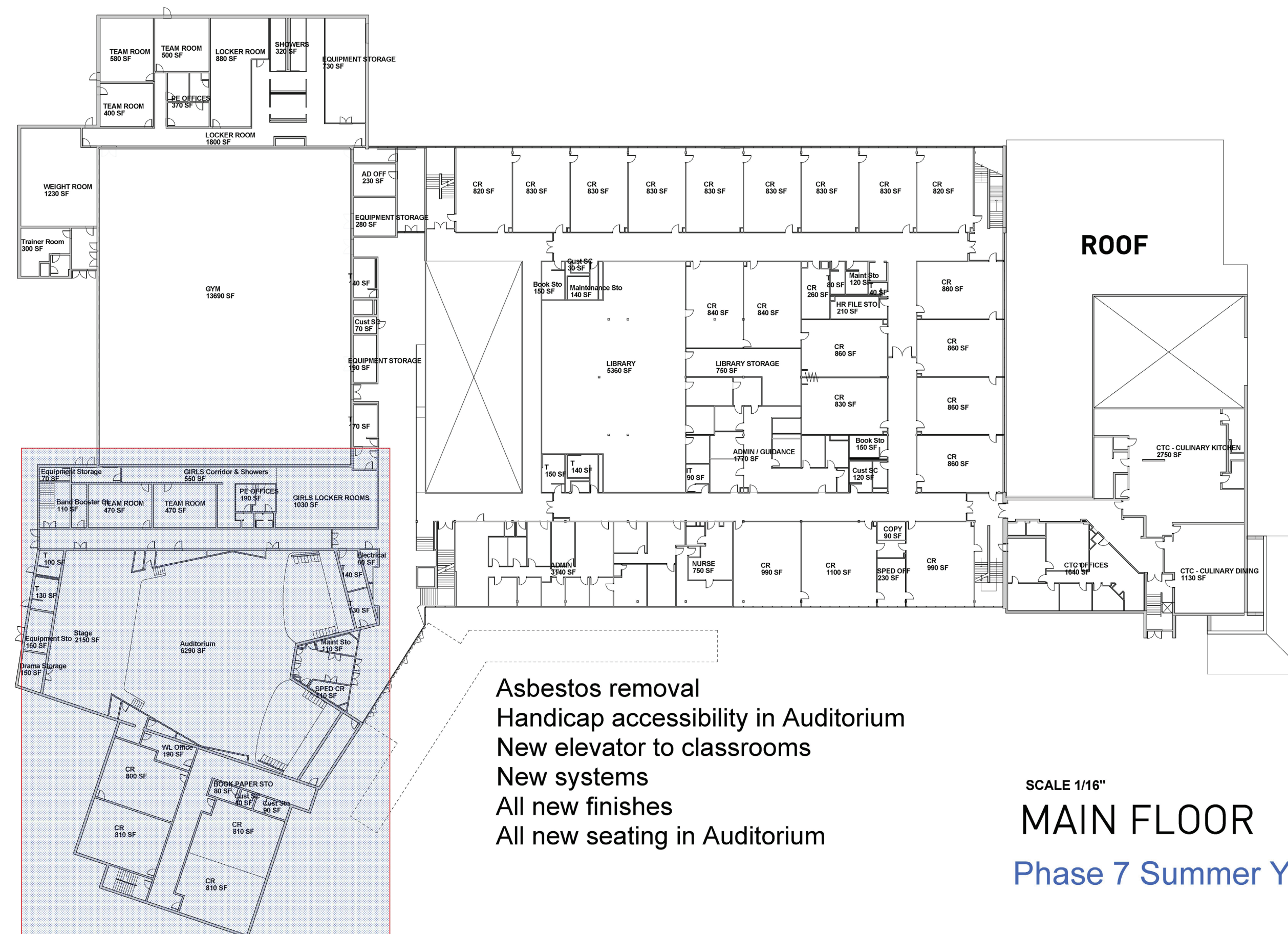

SCALE 1/16"
MAIN FLOOR
 Phase 7 Summer Year 7

Full Rehabilitation - Phase 5, 6 & 7 - Summer Work

Dover HS / CTC

Dover, NH
 Updated 04/21/2015