

**APPROXIMATE REPAIR LOCATIONS**  
SCALE: 1" = 20'-0"

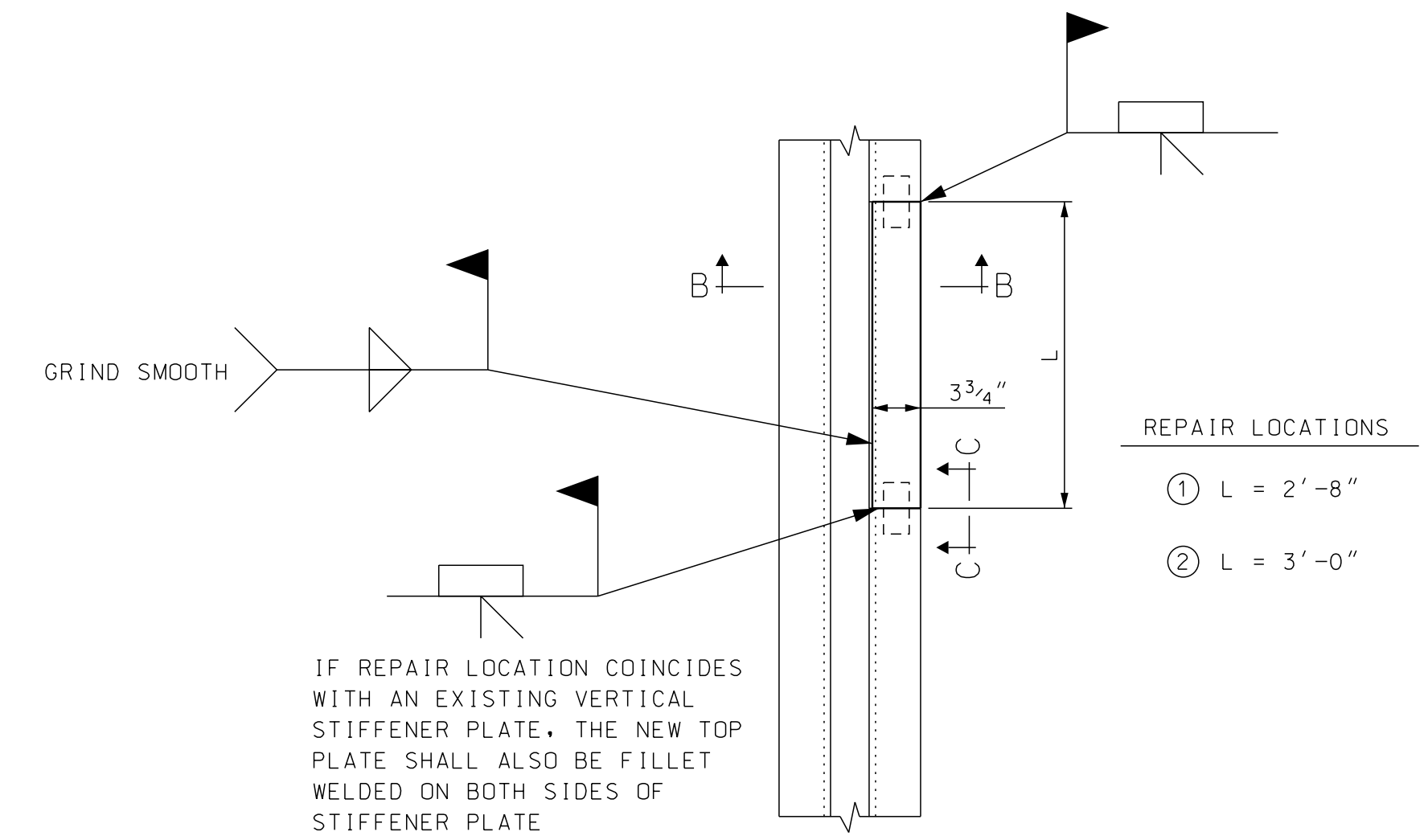

**TYPICAL EXPANSION JOINT ARMOR REPAIR WELDING PLAN**  
SCALE: 1" = 1'-0"

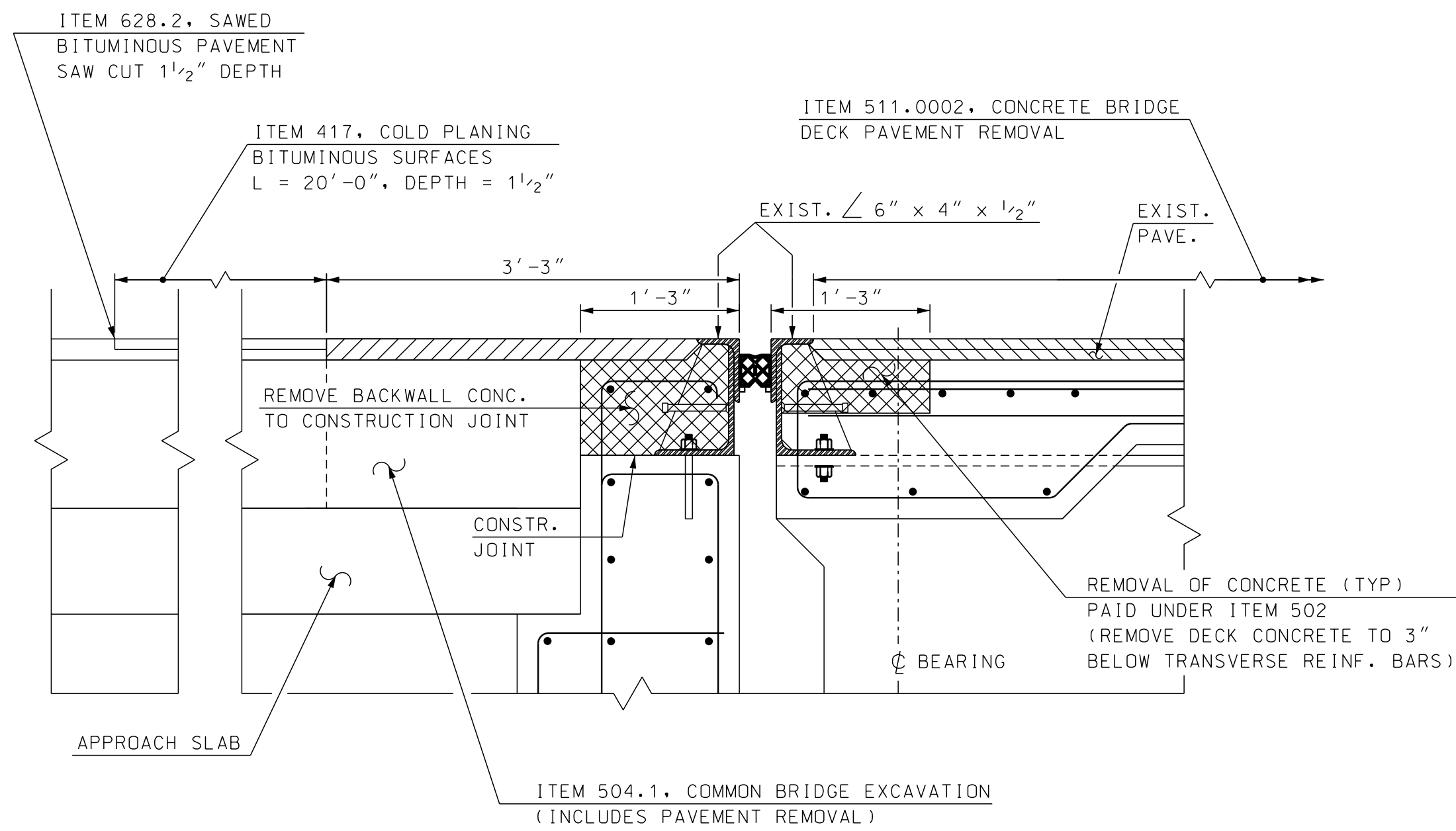

**SECTION A-A - EXISTING ARMORED JOINT DETAIL (REMOVAL LIMITS)**  
SCALE: 1" = 1'-0"

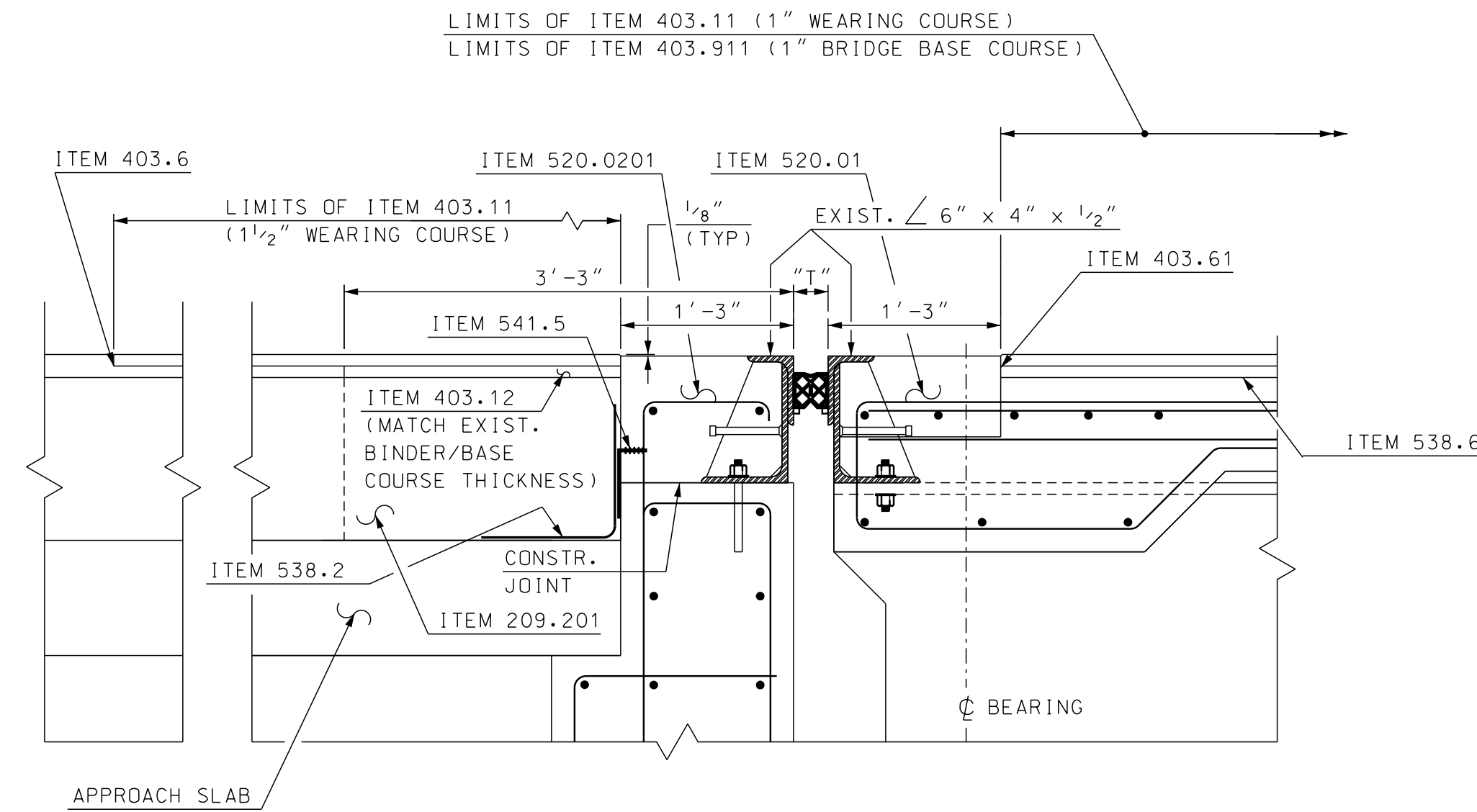

**SECTION A-A - PROPOSED ARMORED JOINT RECONSTRUCTION DETAIL**  
SCALE: 1" = 1'-0"

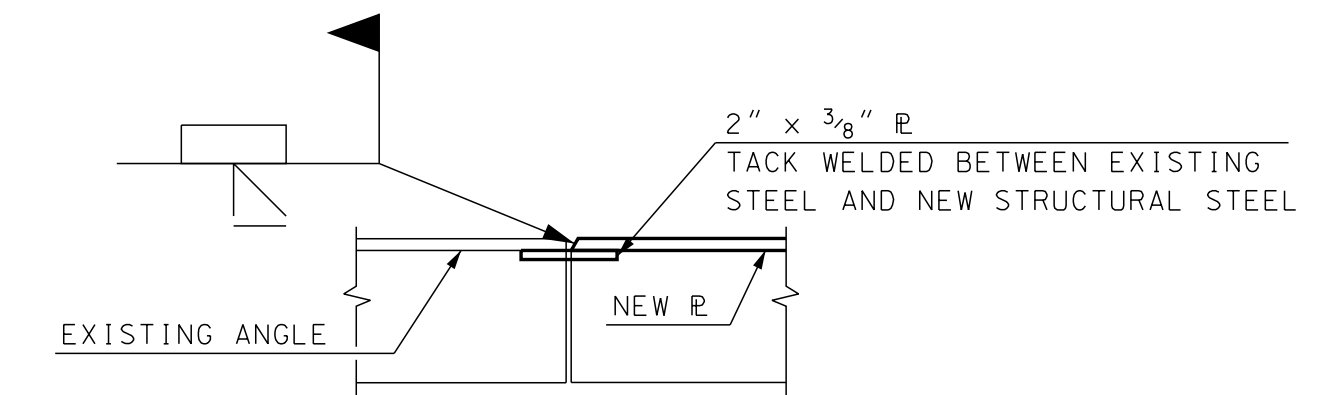

**SECTION C-C - BACKING PLATE DETAIL**  
SCALE: 1 1/2" = 1'-0"

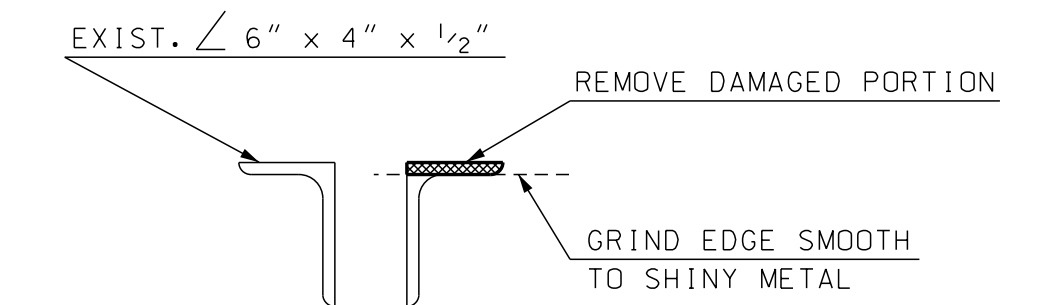

**SECTION B-B - DAMAGED SECTION REMOVAL**  
SCALE: 1 1/2" = 1'-0"

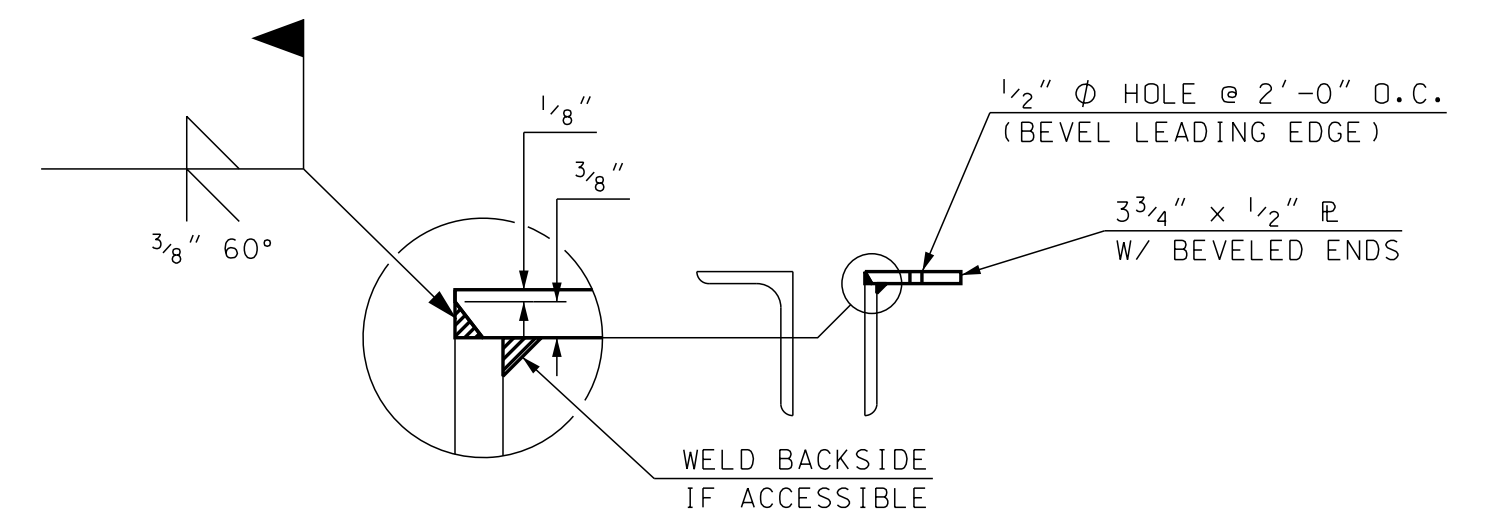

**SECTION B-B - PROPOSED REPAIR DETAIL**  
SCALE: 1 1/2" = 1'-0"

**TEMPERATURE ADJUSTMENT NOTES**

- "T" DIMENSIONS ARE PERPENDICULAR TO FACE OF BACKWALL.
- ADJUST "T" WIDTH FOR NEW SEAL DURING INSTALLATION IF APPLICABLE AND FEASIBLE.
- VALUES IN THE TEMPERATURE ADJUSTMENT TABLE ARE FOR VERIFYING THE EXPANSION JOINT ASSEMBLY OPENING PRIOR TO INSTALLING NEW SEALS.

**EXPANSION JOINT NOTES**

- THE COMPRESSION SEAL SHALL BE FURNISHED IN ONE CONTINUOUS LENGTH. NO SPLICES WILL BE ALLOWED. SEAL SHALL BE INSTALLED USING AN APPROVED TOOL, RECOMMENDED BY THE MANUFACTURER OF THE SEAL, THAT WILL NOT DAMAGE THE SEAL.
- PROTECT TOP OF EXPANSION JOINT DURING PLACEMENT OF CONCRETE AND BITUMINOUS PAVEMENT.
- THE COMPRESSION SEAL HAS BEEN DESIGNED FOR A TOTAL FACTORED MOVEMENT OF 0.96 INCHES. DESIGN INCLUDES MOVEMENT DUE TO TEMPERATURE, SKEW, SHRINKAGE AND MINIMUM INSTALLATION WIDTH. THE CONTRACTOR SHALL USE A CV-2502 BY D.S. BROWN.
- NEW STRUCTURAL STEEL FOR EXPANSION JOINT SHALL BE ASTM A 572, GALVANIZED. GRIND OFF GALVANIZING IN AREAS TO BE WELDED. TOUCH UP GROUND AREAS PER NH STANDARD SPECIFICATION SECTION 550.2.9.1.
- THE COMPRESSION SEALS SHALL BE REPLACED ALONG ENTIRE WIDTH OF BRIDGE, INCLUDING SECTIONS IN CURB AND SIDEWALK.

TEMPERATURE ADJUSTMENT TABLE	
TEMPERATURE	"T"
20°F	1 11/16"
35°F	1 9/16"
50°F	1 1/2"
65°F	1 7/16"
80°F	1 5/16"
95°F	1 1/4"

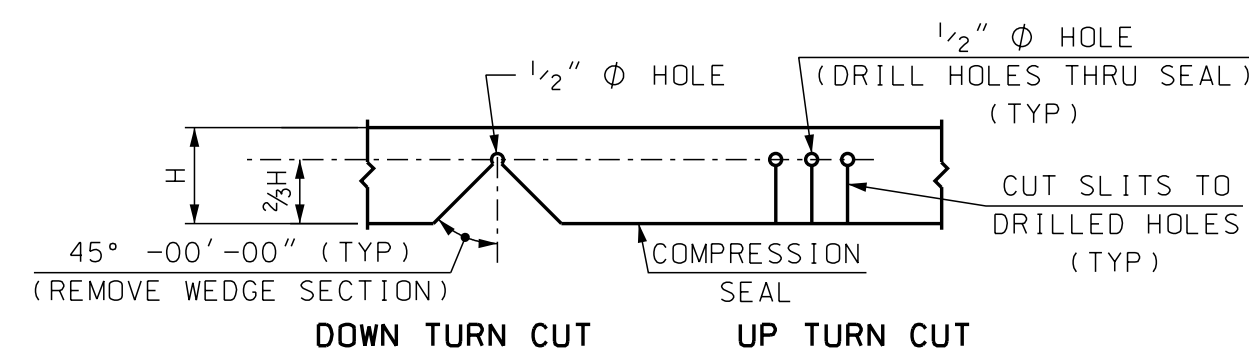

**RELIEF CUT DETAILS**  
NOT TO SCALE

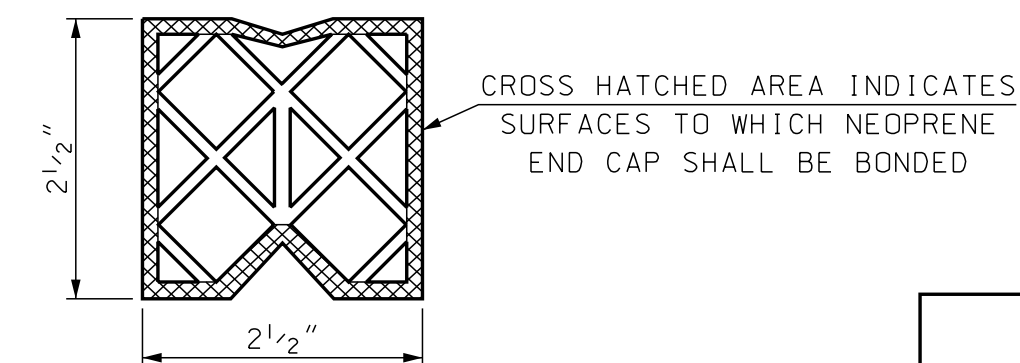

**UNCOMPRESSED SEAL**  
NOT TO SCALE

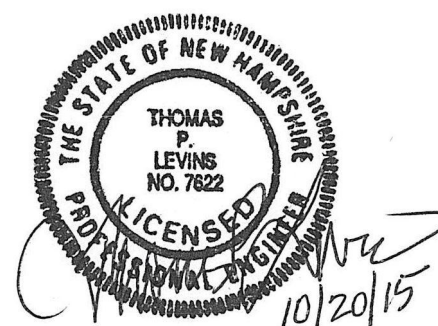

SUBDIRECTORY	DGN LOCATOR	SHEET SCALE
BRD/BSITE	Central Ave ExptDetails	1"=10'

CITY OF DOVER						
DEPARTMENT OF COMMUNITY SERVICES						
TOWN	DOVER	BRIDGE NO.	131/123	STATE PROJECT	---	BRIDGE SHEET
LOCATION	CENTRAL AVENUE					1 OF 2
EXPANSION JOINT REPAIR DETAILS						
DESIGNED	BAW	DATE	9/15	CHECKED	TPL	DATE
DRAWN	BAW	DATE	10/15	CHECKED	TPL	DATE
QUANTITIES	BAW	DATE	10/15	CHECKED	TPL	DATE
ISSUE DATE		FEDERAL PROJECT NO.		SHEET NO.		TOTAL SHEETS
REV. DATE				1		2

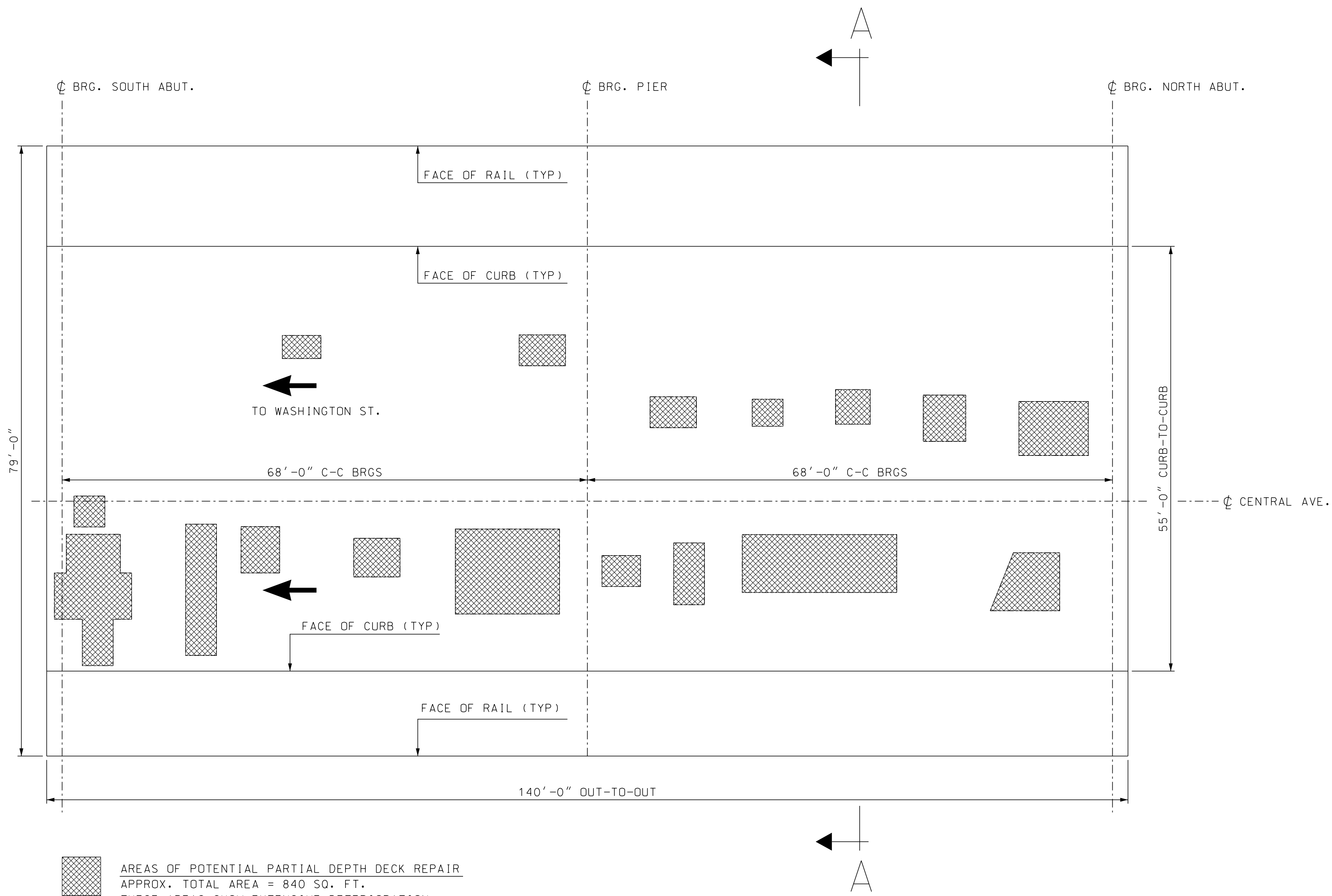
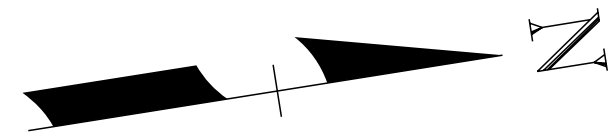

**PLAN**  
SCALE: 1" = 10'-0"

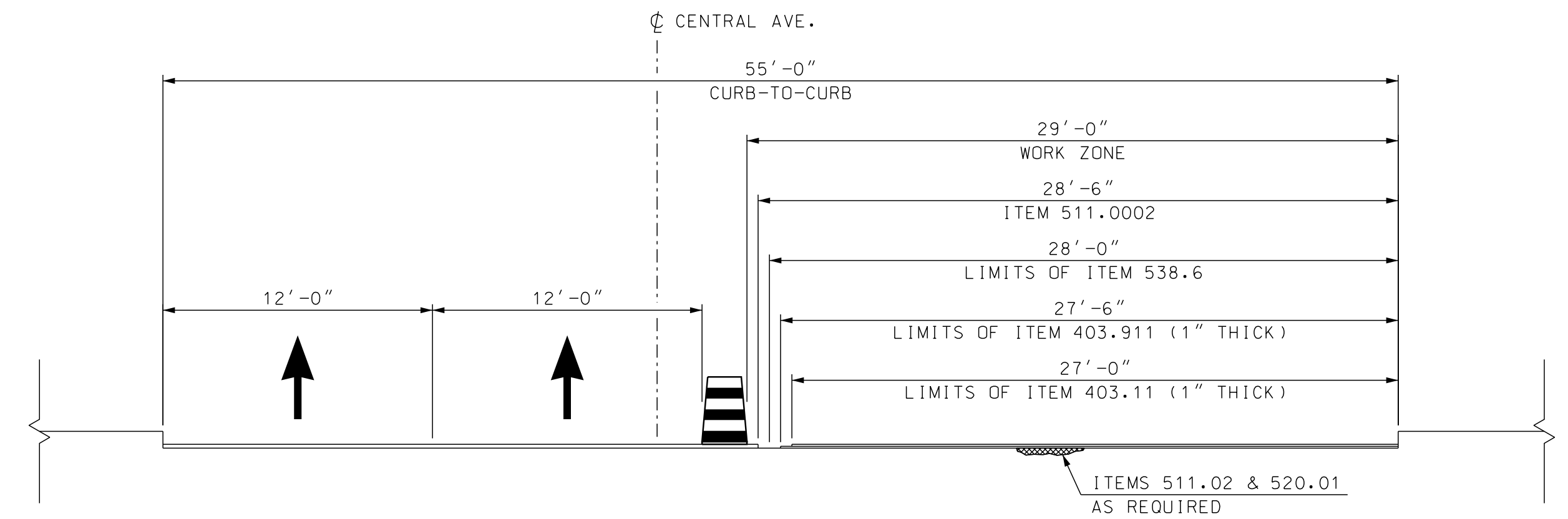

**SECTION A-A - PHASE 1**  
SCALE: 3/16" = 1'-0"

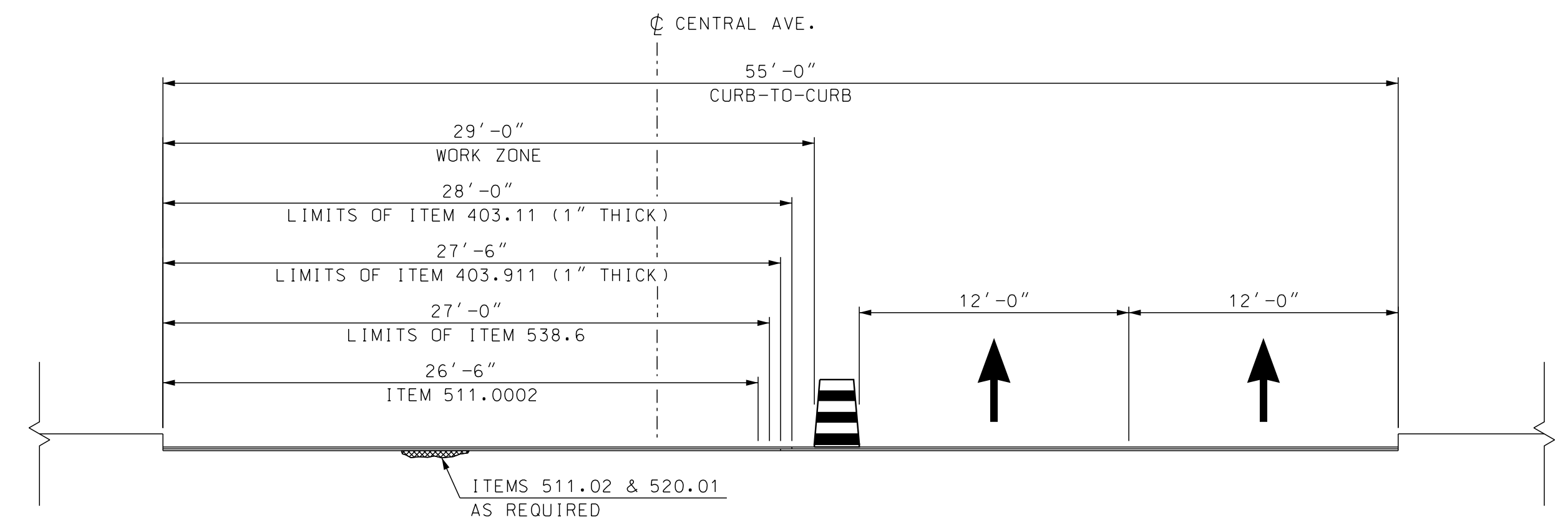

**SECTION A-A - PHASE 2**  
SCALE: 3/16" = 1'-0"

**BRIDGE DECK REHABILITATION NOTES**

- ITEM 511.0002, CONCRETE BRIDGE DECK PAVEMENT REMOVAL (F), SHALL INCLUDE COMPLETE REMOVAL OF THE EXISTING BRIDGE PAVEMENT AND MEMBRANE. EXTREME CARE SHALL BE TAKEN TO NOT DAMAGE THE EXISTING BRIDGE DECK CONCRETE, SCUPPERS, GRANITE CURB, AND CONCRETE SIDEWALKS. REMOVAL SHALL BE DONE IN PHASES AS SHOWN ON THE PLANS. ANY DAMAGE CAUSED BY CONTRACTOR NEGLIGENCE SHALL BE REPAIRED AT THE CONTRACTORS EXPENSE.
- AFTER REMOVAL OF THE EXISTING PAVEMENT AND MEMBRANE, THE EXISTING CONCRETE BRIDGE DECK AND SIDEWALKS SHALL BE INSPECTED TO DETERMINE AREAS REQUIRING PARTIAL DEPTH REPAIRS (ALL COSTS INCLUDED IN ITEM 511.02). DETERIORATED AREAS SHALL BE PATCHED WITH ITEM 520.01, CONCRETE CLASS AA. THE PREPARED AREAS SHALL BE BLAST CLEANED AND SATURATED SURFACE DRY (ALL COSTS INCLUDED IN ITEM 520.01).
- FOR REPLACEMENT OF CONCRETE AT EXPANSION JOINTS, THE EXISTING CONCRETE BRIDGE DECK AND ABUTMENT BACKWALLS SHALL BE REMOVED BETWEEN CURB LINES TO LIMITS SHOWN ON THE PLANS AND PAID UNDER ITEM 502.. REMOVAL OF EXISTING BRIDGE STRUCTURE. ALL CONCRETE SURFACES SHALL BE SAWCUT 1" DEEP TO PROVIDE CLEAN REMOVAL LINES (ALL COSTS INCLUDED IN ITEM 502.) THE BACKWALLS SHALL BE RECONSTRUCTED WITH ITEM 520.0201, CONCRETE CLASS AA, ABOVE FOOTINGS. THE DECK ENDS AND SIDEWALKS SHALL BE RECONSTRUCTED WITH ITEM 520.01, CONCRETE CLASS AA. THE REMOVAL SURFACES SHALL BE BLAST CLEANED AND SATURATED SURFACE DRY (ALL COSTS INCLUDED IN ITEMS 520.01 AND 520.0201).
- ITEM 534.3, WATER REPELLENT (SILANE/SILOXANE), SHALL BE APPLIED TO ALL EXPOSED SURFACES OF NEW CONCRETE.

**GENERAL CONSTRUCTION NOTES**

- THE CONTRACTOR SHOULD BE AWARE THAT EXISTING STRUCTURE DIMENSIONS SHOWN ON THESE PLANS WERE TAKEN FROM NHDOT BRIDGE INSPECTION REPORT INFORMATION AND FROM FIELD MEASUREMENTS. NO EXISTING BRIDGE PLANS WERE AVAILABLE. THE CONTRACTOR SHALL FIELD VERIFY ALL DIMENSIONS OF THE EXISTING STRUCTURE AND BE PREPARED TO MAKE ANY ADJUSTMENTS REQUIRED TO PROPERLY REHABILITATE THE BRIDGE.
- TRAFFIC CONTROL MEASURES SHALL BE IN PLACE BEFORE REMOVAL OPERATIONS BEGIN FOR EACH CONSTRUCTION PHASE.
- THE CONTRACTOR SHALL TAKE ALL NECESSARY MEASURES TO PROTECT EXISTING UTILITIES FROM DAMAGE DURING CONSTRUCTION.

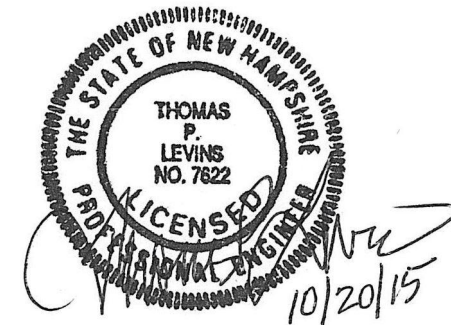

CITY OF DOVER DEPARTMENT OF COMMUNITY SERVICES									
TOWN	DOVER	BRIDGE NO.	131/123	STATE PROJECT	---				
LOCATION	CENTRAL AVENUE								
GENERAL PLAN AND PHASE CONSTRUCTION									
REVISIONS AFTER PROPOSAL		BY	DATE	CHECKED	TPL	DATE	BRIDGE SHEET		
		DESIGNED	BAW	10/15	CHECKED	TPL	10/15	2 OF 2	
		DRAWN	BAW	10/15	CHECKED	TPL	10/15	FILE NUMBER	
		QUANTITIES	BAW	10/15	CHECKED	TPL	10/15	-	
ISSUE DATE		FEDERAL PROJECT NO.			SHEET NO.		TOTAL SHEETS		
REV. DATE		---			2		2		