

JBC Monthly Status Report – December 2016

DHS–CTC Building Project

January 9, 2017



CONSTRUCTION



# Dover High School and Career Technical Center

## Monthly Construction Report No. 4

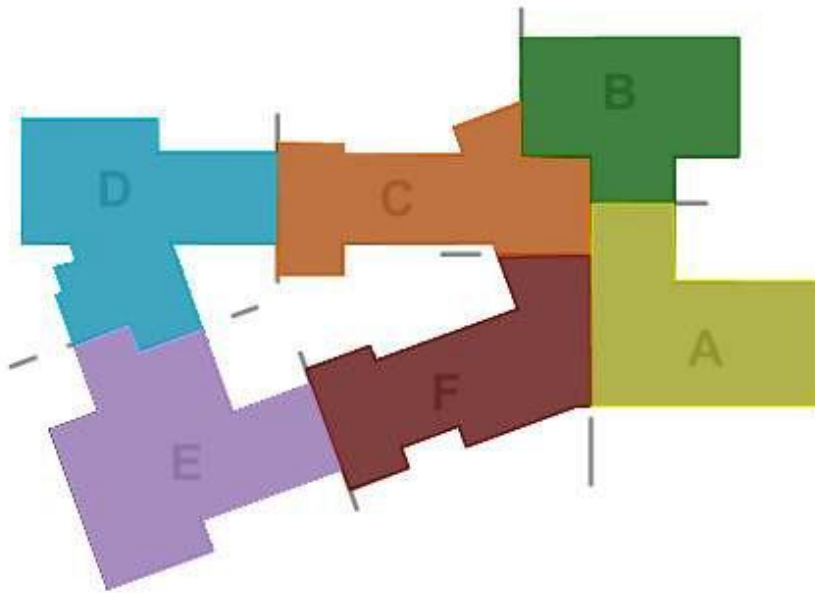

**TABLE OF CONTENTS**

- A. Executive Summary
  - 1. Construction Documents Area Breakout Plan
  - 2. Construction Progress Highlights
  - 3. Critical Issues
  - 4. Summary
  
- B. Construction Status
  - 1. Schedule Building Phase Plan
  - 2. Monthly Construction Schedule Update
  - 3. 3-Week Look Ahead Schedule
  - 4. Schedule Impacts
  - 5. Progress Photos
  
- C. Design Coordination
  - 1. RFI's
  - 2. Submittals
  - 3. Architectural Supplemental Instructions
  
- D. Safety
  - 1. Safety Status
  
- E. Project Financial Status
  - 1. Procurement Update
  - 2. Current Contract Summary
  - 3. Change Order Management
  - 4. Contingency Usage
  - 5. Allowance Usage
  - 6. Billed to Date

**A. Executive Summary:**

1. Construction Documents Area Breakout Plan



- ▶ Area A
  - Ground - Auditorium, Band, Food Service
  - First - Culinary Kitchen/Dining
  - Second - CTC Labs/Classrooms, Staff Dining
- ▶ Area B
  - Ground - Gymnasium, Alt PE, Locker Rooms
  - First - CTC Salon, Labs
  - Second - Life Sciences
- ▶ Area C
  - Ground - MEP, Weight Room, Team rooms, Marketing
  - First - Library, SPED, NJROTC, Offices, Guidance
  - Second - Business CR's, SPED CR's, Typical CR's
- ▶ Area D
  - Ground - N/A
  - First - Building Construction, Electrical, Wood Working, Typical CR's, Art
  - Second - Typical CR's, Sciences & Labs
- ▶ Area E
  - Ground - N/A
  - First - Typical CR's, Photography, Earth Science, Welding, Auto, CTE Offices/Admin
  - Second - Typical CR's, Sciences & Labs
- ▶ Area F
  - Ground - Town Square
  - First - SPED CR's, Pre-Engineering, Photo, Typical CR's, Admin, Nurse, Main Entry
  - Second - Computer, Typical CR's

2. Construction Progress Highlights

- Site utilities are complete for this year with water and storm drain complete.
- Excavation and prep for foundation is ongoing in areas C.
- Foundations are complete in Areas A & B with Area C 50% complete.
- Steel erection for Area B is on-going with Area A steel is on-site

3. Critical Issues

- Receipt of building permits from Inspection Services. Meetings held with Inspection Services to resolve building occupancy, toilet counts, drinking fountain counts and underslab plumbing design.

4. Summary

- The project is currently proceeding smoothly. Safety has been good to date.

**B. Construction Status:**

1. Schedule Phase Plan

- For scheduling purposes, the building is separated into three areas – Building 1, Building 2 and Building 3. These are defined as separate areas separated by a fire rated expansion joint.

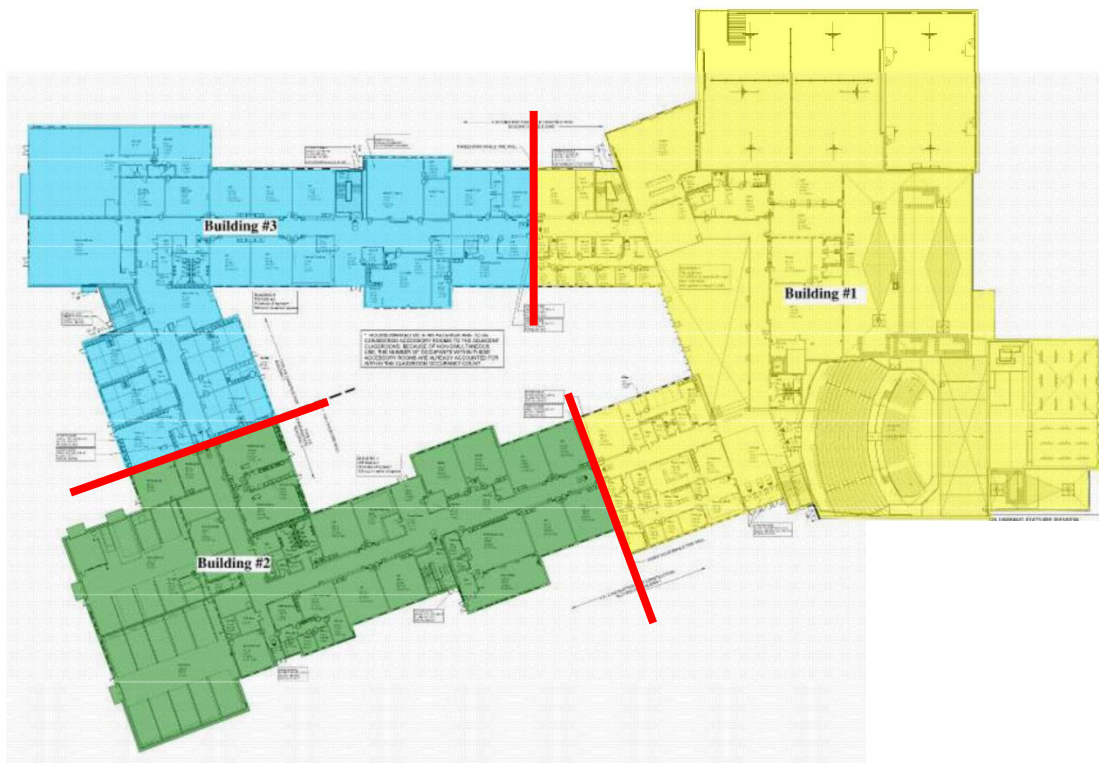

2. Monthly Schedule Update – On-going

3. Three-Week Look Ahead Schedule – Distributed weekly

4. Schedule Impacts

- Analyzing impact of ledge discovered on-site.

## Dover HS & CTC - Monthly Report for December, 2016

- Analyzing impact of code review comments on issuance of construction permits.

### 5. Progress Photos

- Structural Steel (Kitchen Area)



- Orchestra Pit Water Proofing



- Gas Line Installation



- Ductbank across Loop Road



- North Loop Road Pavement



- Gymnasium Trusses



**C. Design Coordination:**

1. RFI Status

- Submitted (170)

Dover HS & CTC - Monthly Report for December, 2016

- Open (04)
- Critical (01)
- 2. Submittals
  - Submitted (218)
  - Open (53)
  - Critical (01)
- 3. ASI's
  - Issued (22)

**D. Safety Update:**

1. PC has a site specific safety program in place for this project. Every worker who comes on site is required to be oriented to the project rules and expectations. Safety has been good to date.

PC's on-site safety specialist does a weekly audit and provide the team with a safety score from 0 to 100. Below are the most recent scores.

Week of 12/5/16 = 91

Week of 12/12/16 = 91

Week of 12/19/16 = 94

Week of 12/26/16 = 88

**E. Project Financial Status:**

1. Procurement Update: Letters of Recommendation (LOR's) Issued and Signed
  - 03.01A Concrete Foundations \$ 1,800,000
  - 03.01B Concrete Flatwork \$ 2,019,559
  - 04.01 Masonry \$ 3,450,000
  - 05.01 Structural Steel \$ 6,400,000
  - 06.01A Architectural Millwork \$ 409,199
  - 06.01B Laboratory Equipment \$ 159,090
  - 07.01 Below Grade Waterproofing \$ 41,600
  - 07.01 Air & Vapor Barrier \$ 445,770
  - 07.02 Roofing and Flashing \$ 1,770,000
  - 07.05 Firestopping \$ 54,750
  - 08.03 Overhead Doors \$ 64,000
  - 09.01 Metal Stud Framing & Drywall \$ 5,550,000
  - 09.02 Acoustical Ceilings \$ 574,473
  - 09.03 Ceramic Tile \$ 640,000
  - 09.03 Resilient Flooring \$ 953,000
  - 09.06 Painting \$ 600,000
  - 10.01 Miscellaneous Accessories \$ 601,678
  - 11.01 Kitchen Equipment \$ 467,822
  - 12.02 Gymnasium and Auditorium Seating \$ 261,823
  - 14.01 Elevators \$ 211,131



Dover HS & CTC - Monthly Report for December, 2016

• 21.01 Fire Protection	\$ 540,000
• 23.01 Plumbing	\$ 2,490,000
• 23.01 Ductwork	\$ 2,645,270
• 23.02 Automatic Temperature Controls	\$ 761,465
• 23.04 Condensing Boilers	\$ 99,108
• 23.05 Air Handling Equipment & Chiller	\$ 1,690,000
• 26.01 Electrical, Telecom & Security	\$ 6,784,800
• 31.01 Sitework	\$ 4,546,082
• 31.02 Rammed Aggregate Piers	\$ 285,917
• 31.03 Turf Field	\$ 417,250

○ Total to Date \$46,733,787

2. Current Contract Summary

• Base Contract:	\$71,643,000
• Approved Changes to Date No.1	\$ 54,141
• Current Contract amount:	\$71,697,141

3. Change Order Management:

Previously Approved Proposals	\$ 54,141
Proposals to be included in CO No. 2:	
• 190010	\$ 3,705
• 190021	(\$ 1,657)
• 190022	\$ 2,197
• 190023	\$ 15,015
• 190029	(\$ 6,953)
• 190034	\$ 0
• Total	\$ 12,307

4. Contingency Usage

• Carried:	\$ 1,700,000
• Committed to Date:	\$ 4,275
• Remaining:	\$ 1,695,725

5. Allowance Status

	<u>Used</u>	<u>Remaining</u>
• Hazardous Abatement	\$900	\$ 1,091,100
• Animal Science Building	\$0	\$ 1,200,000
• Climbing Wall	\$0	\$ 35,000

6. Application for Payment Status

• Requisitioned to Date Thru #7	\$ 7,011,461
• Current Retained Amount	\$ 270,035
• Remaining to be Billed	\$64,955,715